

PROPERTY MAP
TOWN OF
EAGLE LAKE

ARROOSTOOK COUNTY
MAINE

1978

PREPARED BY
S.L.F., Inc.
SKOWHEGAN MAINE

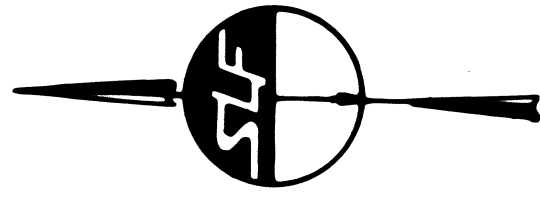

SCALE
1" = 100'
0 50 100 150'

LEGEND
FLOOD HAZARD LIMITS
PARCEL NUMBER
ADJACENT MAPS
MATCH LINE

NOTE:
FOR ASSESSMENT PURPOSES ONLY
NOT TO BE USED FOR CONVEYANCES

APRIL 1, 2016

REVISION
MATTHEW MACDONALD
BOUNDARY CONSULTANT
MADAWASKA, MAINE

No lot numbers 93, 65, 74, 114, 115, 47, 71, 67

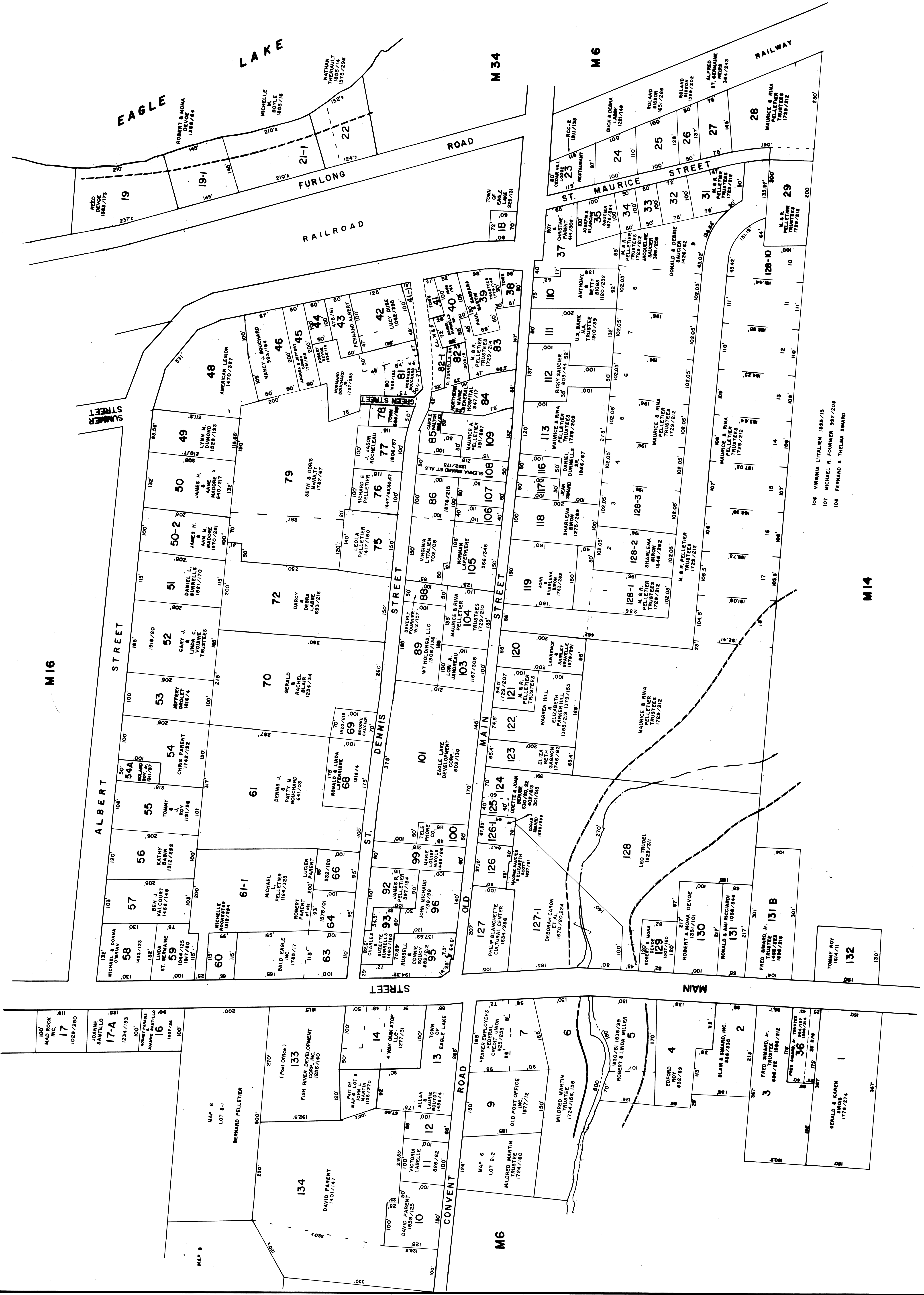

100' MAD ROCK INC. 17 1029/250

17-A 17 1234/193

16 1897/88

134 DAVID PARENT 140/147

133 FISH RIVER DEVELOPMENT COMP. INC. 1256/140

14 1277/31

10 DAVID PARENT 1859/125

11 VICTORIA LABELLE 858/82

12 ALLAN LANE 1488/74

9 MILDRED MARTIN TRUSTEE 1724/160

7 FRASER EMPLOYEES FEDERAL UNION 320/253

6 MILDRED MARTIN 1724/158

5 EDWARD ROY 832/49

4 EDWARD ROY 832/49

3 FRED SHWARD, JR. TRUSTEE 886/22

2 BLAIR & SHWARD, INC. 582/333

1 GERALD & KAREN 1778/214

132 TOMMY ROY 1814/11

131 B 1888/218

130 ROBERT & MONA DEVOE 1381/101

129 MONA DEVOE 1307/160

128 LEO TRUDEL 1829/311

127 PHILIP BLANCHETTE CULTURAL CENTER 1534/286

126 MAURICE & RINA PELLETIER TRUSTEES 1827/81

125 ODETTE & JOHN 402/212

124 ELIZABETH ANKER HILL 1747/42

123 BETH ANKER HILL 1355/219/195

122 WARREN HILL 1729/207

121 A. S. R. TRUSTEES

120 LAWRENCE SHARLENA SHWARD 1878/289

119 JOHN SHARLENA SHWARD 1743/282

118 SHARLENA SHWARD 1278/289

117 MAURICE & RINA PELLETIER TRUSTEES 1729/212

116 MAURICE & RINA PELLETIER TRUSTEES 1729/212

115 MAURICE & RINA PELLETIER TRUSTEES 1729/212

114 MAURICE & RINA PELLETIER TRUSTEES 1729/212

113 MAURICE & RINA PELLETIER TRUSTEES 1729/212

112 RICKY FACIER 35/803/44/32

111 ANTHONY BETTY TRUSTEES 1120/232

110 U.S. BANK TRUSTEES 1910/33

109 DONALD & DEBBIE 1438/12

108 DONALD & DEBBIE 1438/12

107 DONALD & DEBBIE 1438/12

106 DONALD & DEBBIE 1438/12

105 DONALD & DEBBIE 1438/12

104 DONALD & DEBBIE 1438/12

103 DONALD & DEBBIE 1438/12

102 DONALD & DEBBIE 1438/12

101 DONALD & DEBBIE 1438/12

100 DONALD & DEBBIE 1438/12

99 DONALD & DEBBIE 1438/12

98 DONALD & DEBBIE 1438/12

97 DONALD & DEBBIE 1438/12

96 DONALD & DEBBIE 1438/12

95 DONALD & DEBBIE 1438/12

94 DONALD & DEBBIE 1438/12

93 DONALD & DEBBIE 1438/12

92 DONALD & DEBBIE 1438/12

91 DONALD & DEBBIE 1438/12

90 DONALD & DEBBIE 1438/12

89 DONALD & DEBBIE 1438/12

88 DONALD & DEBBIE 1438/12

87 DONALD & DEBBIE 1438/12

86 DONALD & DEBBIE 1438/12

85 DONALD & DEBBIE 1438/12

84 DONALD & DEBBIE 1438/12

83 DONALD & DEBBIE 1438/12

82 DONALD & DEBBIE 1438/12

81 DONALD & DEBBIE 1438/12

80 DONALD & DEBBIE 1438/12

79 DONALD & DEBBIE 1438/12

78 DONALD & DEBBIE 1438/12

77 DONALD & DEBBIE 1438/12

76 DONALD & DEBBIE 1438/12

75 DONALD & DEBBIE 1438/12

74 DONALD & DEBBIE 1438/12

73 DONALD & DEBBIE 1438/12

72 DONALD & DEBBIE 1438/12

71 DONALD & DEBBIE 1438/12

70 DONALD & DEBBIE 1438/12

69 DONALD & DEBBIE 1438/12

68 DONALD & DEBBIE 1438/12

67 DONALD & DEBBIE 1438/12

66 DONALD & DEBBIE 1438/12

65 DONALD & DEBBIE 1438/12

64 DONALD & DEBBIE 1438/12

63 DONALD & DEBBIE 1438/12

62 DONALD & DEBBIE 1438/12

61 DONALD & DEBBIE 1438/12

60 DONALD & DEBBIE 1438/12

59 DONALD & DEBBIE 1438/12

58 DONALD & DEBBIE 1438/12

57 DONALD & DEBBIE 1438/12

56 DONALD & DEBBIE 1438/12

55 DONALD & DEBBIE 1438/12

54 DONALD & DEBBIE 1438/12

53 DONALD & DEBBIE 1438/12

52 DONALD & DEBBIE 1438/12

51 DONALD & DEBBIE 1438/12

50-2 DONALD & DEBBIE 1438/12

50 DONALD & DEBBIE 1438/12

49 DONALD & DEBBIE 1438/12

48 DONALD & DEBBIE 1438/12

47 DONALD & DEBBIE 1438/12

46 DONALD & DEBBIE 1438/12

45 DONALD & DEBBIE 1438/12

44 DONALD & DEBBIE 1438/12

43 DONALD & DEBBIE 1438/12

42 DONALD & DEBBIE 1438/12

41 DONALD & DEBBIE 1438/12

40 DONALD & DEBBIE 1438/12

39 DONALD & DEBBIE 1438/12

38 DONALD & DEBBIE 1438/12

37 DONALD & DEBBIE 1438/12

36 DONALD & DEBBIE 1438/12

35 DONALD & DEBBIE 1438/12

34 DONALD & DEBBIE 1438/12

33 DONALD & DEBBIE 1438/12

32 DONALD & DEBBIE 1438/12

31 DONALD & DEBBIE 1438/12

30 DONALD & DEBBIE 1438/12

29 DONALD & DEBBIE 1438/12

28 DONALD & DEBBIE 1438/12

27 DONALD & DEBBIE 1438/12

26 DONALD & DEBBIE 1438/12

25 DONALD & DEBBIE 1438/12

24 DONALD & DEBBIE 1438/12

23 DONALD & DEBBIE 1438/12

22 DONALD & DEBBIE 1438/12

21 DONALD & DEBBIE 1438/12

20 DONALD & DEBBIE 1438/12

19 DONALD & DEBBIE 1438/12

18 DONALD & DEBBIE 1438/12

17 DONALD & DEBBIE 1438/12

16 DONALD & DEBBIE 1438/12

15 DONALD & DEBBIE 1438/12

14 DONALD & DEBBIE 1438/12

13 DONALD & DEBBIE 1438/12

12 DONALD & DEBBIE 1438/12

11 DONALD & DEBBIE 1438/12

10 DONALD & DEBBIE 1438/12

9 DONALD & DEBBIE 1438/12

8 DONALD & DEBBIE 1438/12

7 DONALD & DEBBIE 1438/12

6 DONALD & DEBBIE 1438/12

5 DONALD & DEBBIE 1438/12

4 DONALD & DEBBIE 1438/12

3 DONALD & DEBBIE 1438/12

2 DONALD & DEBBIE 1438/12

1 DONALD & DEBBIE 1438/12